



ASPEN POU INDICATOR INSTRUCTION

THANK YOU FOR PURCHASING THE POINT OF USE ASSEMBLY KIT

RECEIVING

Inspect the box for any evidence of shipping or handling damage. In case of shipping damage, claims should be filed promptly with the carrier.

Failure to use an appropriate anti-flood device for any reason will not obligate or make Crystal Mountain responsible in any way for Product Liability issues relating to any claims, including water damage claims.

SPECIFICATION OF POU INDICATOR

1. The POU assembly has been designed to fit on Aspen.
2. The operating pressure 45 PSI.
3. Flow capacity > 1000 ml/min at 45 PSI.
4. Water Inlet Pressure: Minimum 20 PSI (0.138 Mpa) Maximum 80 PSI (0.552 Mpa)
Where pressures may exceed 80 PSI (0.552 Mpa) or if installed above the ground floor a Pressure Reducing Valve must be fitted
5. Indicator function: Indicator will show working valve's failure or any leak from the tubing or fittings inside the reservoir. The bottom float is designated as the primary valve with the top float acting as the safety valve. The top float stops water flow thereby tripping and locking the indicator into the **RED** position.
6. Determine the cause of the failure before resetting the indicator switch to the **GREEN** position.

INSTALLATION OF POU ASSEMBLY

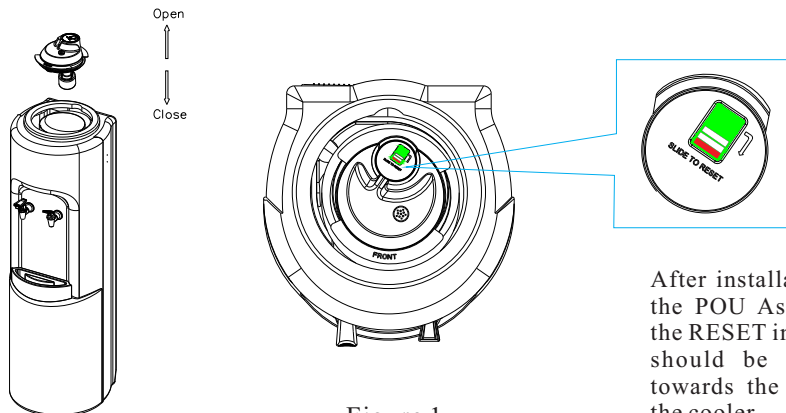

Figure 1

After installation of the POU Assembly, the RESET indicator should be located towards the rear of the cooler

1. Remove POU Assembly from kit box – kit includes POU assembly, POU Cover, and instructions.
2. Ensure that both floats are positioned downwards.
3. Remove the existing lid by turning counter clockwise, aligning the “OPEN” arrow with the marking on the cabinet, then lifting upwards at the rear of the cooler.
4. Install the POU assembly onto the cooler as per Figure 1. Position tubing so that it exits from the rear of the cooler as per Figure 2.

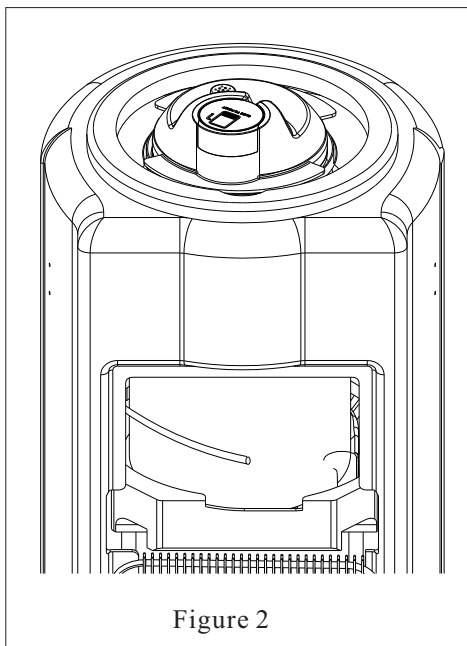

Figure 2

5. Customer to use an applicable 1/4" connector to be positioned between the POU tubing inlet and the water source.

NOTE: Plastic clips may be used to secure any excess 1/4" tubing to the top part of the condenser.

CHECK INDICATOR

If indicator shows **RED**, slide the lever forward to reset the indicator back to **GREEN**. Ensure that indicator is in the **GREEN** position after installation is complete.

CLEANING

Prior to installation and for periodic cleaning, rinse the POU Assembly with water and a mild dishwashing liquid detergent. **DO NOT USE** bleach or abrasive cleaners.

STRUCTURE AND PARTS

See Figure 3

P POU Kit Assembly

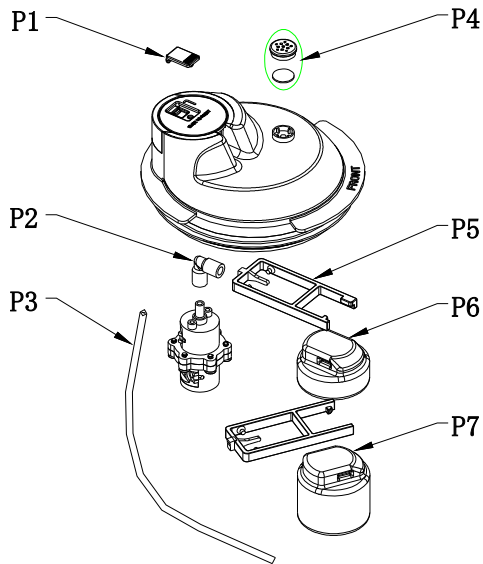

PARTS LIST

No.	DESCRIPTION	PART CODE
	Aspen POU Kit + White Cover, Boxed	SUB-C100292
	Aspen POU Kit + Black Cover, Boxed	SUB-C100293
P1	INDICATOR ASSM-CLEAR WINDOW	SIL-C100010
P2	1/4" POU PLASTIC ELBOWS	MIS-C000044
P3	PE Tubing, 1/4in OD, Black - JG	SIL-C100086
P4	DRYGUARD FILTER/CAP ASSM	SUB-C000199
P5	Float Arm, EV POU	PLC-C140035
P6	EV POU Float - Small	PLC-C140042
P7	EV POU Float - Big	PLC-C140041

CRYSTAL MOUNTAIN LIMITED WARRANTY

Crystal Mountain warrants the POU Assembly Kit against defects and workmanship under normal use, when installed and operated in accordance with the installation instructions.

One (1) year from the date of sale, Crystal Mountain at their option, will repair or replace any defective parts, during this period.

This warranty does not cover any damage due to accident, freight damage, misuse, abuse, and negligence; fouling of components due to liming, dirt, unsatisfactory water conditions or faulty plumbing. Crystal Mountain does not accept responsibility for personal injury resulting from misuse of equipment.

Unauthorized service work and finish deterioration due to normal use cannot be claimed under this warranty.

The customer acknowledges that water, like other liquids, can cause damage to property and surfaces. The customer takes full responsibility for placing the cooler within a residence, business or other location, and acknowledges that failure to address drips, leaks or spillages is at the customer's risk.

Failure to use an appropriate anti-flood device for any reason will not obligate or make Crystal Mountain responsible in any way for Product Liability issues relating to any claims, including water damage claims.