



***SmartFlo™ Water Cartridge  
Replacement***

## Replacement of SmartFlo™ Water Cartridge

For the best quality and tasting water, it is recommended to change the SmartFlo™ Water Cartridge every 12 months. Follow the steps below to replace the SmartFlo™ Water Cartridge. Recommend to empty the bottle installed in the cooler prior to replacement of the SmartFlo™ Water Cartridge and Bottle Adaptor.

**Note:** To reset the life timer system, the SmartFlo™ is required to be removed from the dispenser for a minimum of 15 seconds while the unit is connected to the mains power supply.

1. Open Dispenser Door (Figure 1). (Slide door upwards to allow access to bottle area)
2. Slide empty bottle out of cabinet (Figure 2)
3. Open the replacement SmartFlo™ Water Cartridge kit and take red plug from kit. Disconnect the water line from the bottle adaptor (Figure 3) and add red plug to waterline (Figure 4)

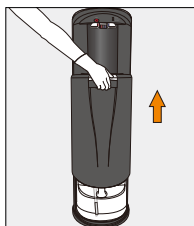

Figure 1

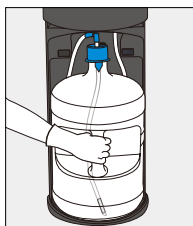

Figure 2

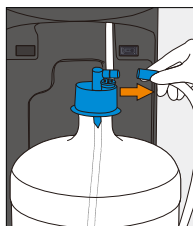

Figure 3

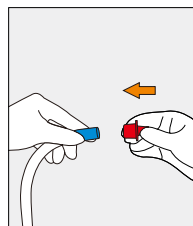

Figure 4

4. Open the replacement SmartFlo™ Water Cartridge kit, and remove the **access key** provided
5. Insert the **access key** into the 2 holes located at the underside of the top edge of the cooler (above water levers) and push inwards (Figure 5 and Figure 6) (once unlocked, the front of the top cover opens upwards)
6. Place a glass or other container below the water outlets (to catch drips), and unlatch the locking clip located near the front of the cooler to release the water tubing (Figure 7)
7. Unlock the turn knobs which hold down the SmartFlo™ Water Cartridge (Figure 8)

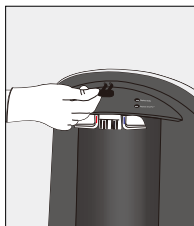

Figure 5

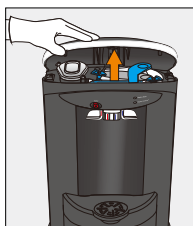

Figure 6

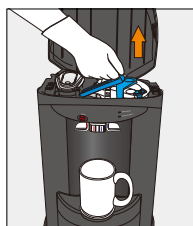

Figure 7

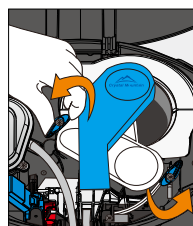

Figure 8

8. Pull SmartFlo™ Water Cartridge upwards to remove (Figure 9)
9. Discard used SmartFlo™ Water Cartridge according to local regulations. (Please recycle)  
To prevent possible harm to the environment or human health from uncontrolled waste disposal, recycle it responsibly to promote the reuse of sustainable resources.
10. Insert water line of replacement SmartFlo™ Water Cartridge through the guide tube, and push through to bottle installation area (Figure 10).

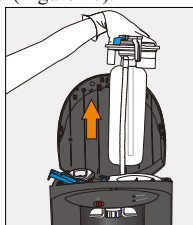

Figure 9

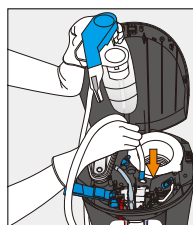

Figure 10

11. Ensure seal is properly installed on the outlet tube of the SmartFlo™ Water Cartridge assembly (may have shifted during shipment or un-packaging)
12. Align SmartFlo™ Water Cartridge with openings in cooler, and push into place
13. Rotate turn knobs to lock SmartFlo™ Water Cartridge in place (Figure 11)
14. Close the locking clip to secure water outlet tubing in place (Figure 12)
15. Close the top cover of the cooler (Figure 13) (push downwards to lock into place)

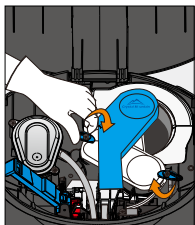

Figure 11

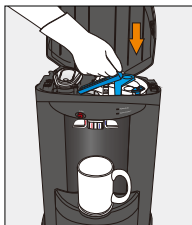

Figure 12

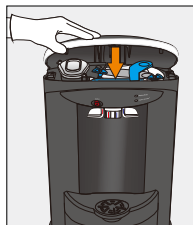

Figure 13

16. Place fresh bottle outside of the cabinet
17. Clean the outside of the new bottle with a cloth. Remove security label/seal from the bottle cap (if applicable)
18. Remove bottle adaptor assembly from the empty bottle (Figure 14), and set aside. Carefully un-package the Bottle Adaptor assembly, avoiding touching the tube.

**Note:** to maintain sanitization of the system, refrain from touching the blue section of the bottle adaptor tube that is inserted into the bottle

19. Without touching the tube, install the Spike Cap (with the end of the tube in the Spike Cap) (Figure 15)
20. Push the tube to go through the Spike Cap, until it is close/hits bottom of the bottle (Figure 16)
21. Remove red protective cap from the blue tube of the Smartflo™ Water Cartridge and install onto the bottle adaptor assembly (Figure 17)

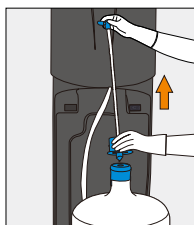

Figure 14

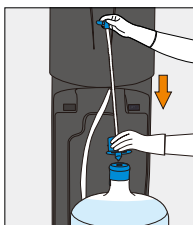

Figure 15

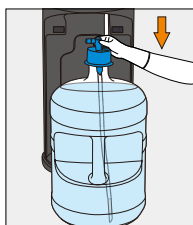

Figure 16

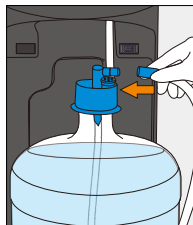

Figure 17

22. Slide bottle into cabinet and close the door (Figure 18 to Figure 20) (slide door downwards to close)
23. Depress the **Cold** and **Hot** water levers to fill their respective tanks.
24. When water begins to flow from both faucets, the tanks have been filled (approximately 1 minute per tank)

**CAUTION! ALWAYS DRAIN WATER COMPLETELY BEFORE SHIPPING OR STORING THE COOLER!**

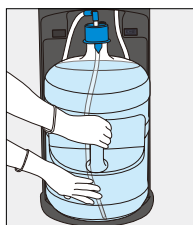

Figure 18

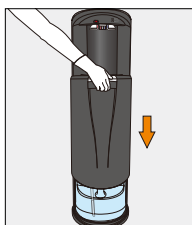

Figure 19

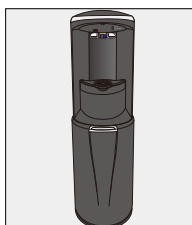

Figure 20

## Warning

- This product dispenses water at very high temperatures. Failure to use properly can cause personal injury.
- This dispenser is intended for dispensing water only. Do NOT use other liquids. Never use any other liquid in the dispenser other than known and microbiologically safe bottle water.
- This appliance is not intended for use by persons (including children) with reduced physical, sensory or mental capabilities, or lack of experience and knowledge, unless they have been given supervision or instruction concerning use of the appliance by a person responsible for their safety.
- Children should be supervised to ensure that they do not play with the appliance.
- Use with caution only

The customer acknowledges that water, like other liquids, can cause damage to surfaces. The customer takes full responsibility for placing the cooler within a residence or business, and acknowledges that failure to address drips, leaks or spillages is at the customer's risk.

The Warranty and Underwriters' Laboratory for the coolers are invalidated if any alteration, modification, or use or misuse in combination with any other machine or devices is deemed to be the source of any claim. The manufacturer accepts no liability (including for bodily injury) resulting from any alteration, misuse, neglect, accidents, improper installations or repairs.

---