

# Product Specification & Parts Listing

## MOGUL

With its smooth classic lines the Mogul cooler will compliment any decor. The contoured drip tray enhances the shape of the cabinet and conveniently holds a cup or glass for hands free filling.



### Model: Mogul 100-115VAC

#### Standard Cooler Specifications and Performance Data

ITEM		SPECIFICATIONS
POWER RATING		SINGLE PHASE
		100-115VAC 60Hz
STANDARD CURRENT		H&C: 6.2A , C&C: 1.2A
POWER CONSUMPTION	COLD	80W
	HOT	450W
COLD	COMPRESSOR	SINGLE PHASE MOTOR
	REFRIGERANT	R-134a (30g)
	TEMP RANGE	6°C ± 3°C (43°F ± 6°F)
	TEMP. CONTROL	THERMOSTAT (ON 0°C TO 8.9°C ±1.5°C) (OFF -17.8°C ±1.5°C)
HOT	HEATER	BAND HEATER
	TEMP RANGE	74°C - 92°C (165.2°F - 197.6°F)
	SAFETY DEVICE	BIMETAL (MANUAL RESET 95°C OFF)
	TEMP CONTROL	BIMETAL (82°C - 89°C)
NOISE(SOUND POWER LEVEL)		38dB(A)
NET WEIGHT		H&C: 13.8kg , C&C: 12.8kg
DIMENSION		315(W)x325(D)x985(H)mm

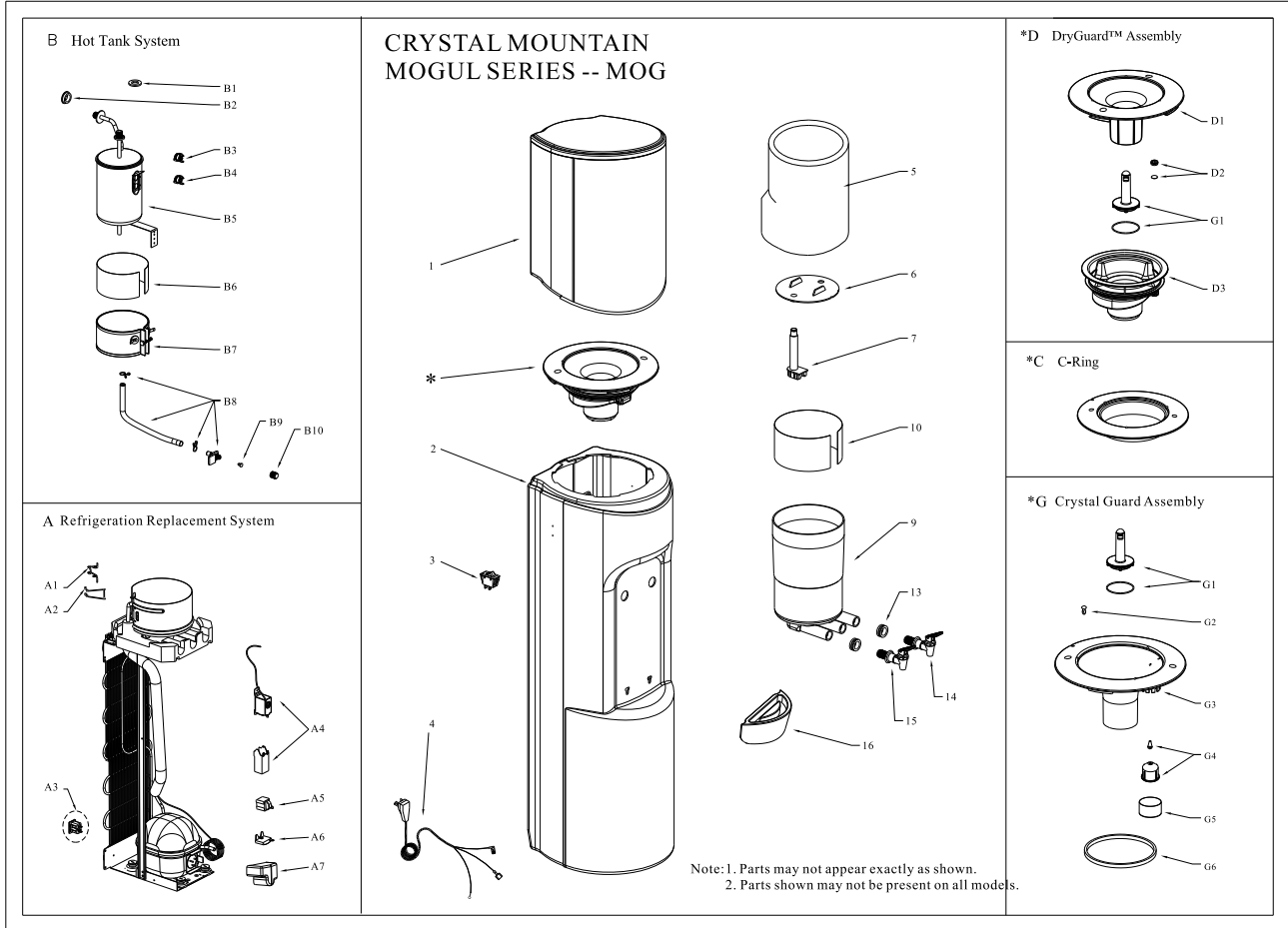

**CRYSTAL MOUNTAIN  
115V MOGUL SERIES (MOG) BOTTLE TYPE WATER COOLER**

NO.	DESCRIPTION	PART CODE	NO.	DESCRIPTION	PART CODE		
1	MOGUL BOTTLE COVER - WHITE	SUB-C000156	B	HOT TANK SYSTEM - R RESERVOIR - SLIDE TYPE	SUB-C000089		
	MOGUL BOTTLE COVER - GRANITE	SUB-C000177		HOT TANK SYSTEM - R RESERVOIR - SCREW TYPE	SUB-C100101		
2	MOGUL BODY - WHITE	SUB-C000158		B1	INLET GASKET	SIL-C000002	
	MOGUL BODY - GRANITE	SUB-C000183		B2	HOT FAUCET GASKET	SIL-C100018	
3	POWER SWITCH	ELE-C000010		B3	MANUAL RESET 95C - SLIDE TYPE	ELE-C000054	
4	POWER CORD 115V C&C	ELE-C100017			MANUAL RESET 95C - SCREW TYPE	ELE-C100088	
5	POWER CORD 115V H&C	ELE-C100018		B4	AUTO RESET 87C - SLIDE TYPE	ELE-C000053	
	R RESERVOIR INSULATION TOP	REF-C000026			AUTO RESET 85C - SCREW TYPE	ELE-C100110	
6	BAFFLE DISC	PLC-C000073		B5	HOT TANK FOR R RESERVOIR - SLIDE TYPE	SMT-C000134	
7	C&C BAFFLE STEM	PLC-C000123		HOT TANK FOR R RESERVOIR - SCREW TYPE	SMT-C100044		
	H&C BAFFLE	PLC-C000107	B6	NOMEX PAPER	MIS-C000041		
9	R RESERVOIR - C&C	PLC-C000095	B7	115V MICA HEATER BANDS	ELE-C000051		
10	R RESERVOIR - H&C	PLC-C000118	B8	HT DRAIN TUBE ASSEMBLY	SUB-C000174		
13	EVAPORATOR GASKET PAPER	MIS-C000049	B9	RED DRAIN CAP PLUG	SIL-C100055		
14	COOK / COLD FAUCET GASKET	SIL-C000025	B10	HOT TANK DRAIN CAP	PLC-C100004		
	FAUCET MALE WHITE / BLUE	FAU-C000048					
	FAUCET MALE BLACK / BLACK	FAU-C000055					
15	FAUCET MALE WHITE / WHITE	FAU-C000049	C	C-RING WHITE BOXED	SUB-C000162		
	FAUCET MALE BLACK / WHITE	FAU-C000061		C-RING GRANITE BOXED	SUB-C000163		
	FAUCET FEMALE WHITE / RED CHILDPROOF	FAU-C000035					
15A	FAUCET FEMALE BLACK / RED CHILDPROOF	FAU-C000063	D	DryGuard™ ASSEMBLY WHITE	SUB-C100013		
	MOGUL DRIP TRAY - GRANITE	PLC-C000187		DryGuard™ ASSEMBLY GRANITE	SUB-C100014		
16	MOGUL DRIP TRAY - BLACK	PLC-C000186		D1	OUTER DryGuard™ COVER WHITE	PLC-C100045	
				D2	OUTER DryGuard™ COVER GRANITE	PLC-C100080	
			D3	DryGuard™ FILTER ASSEMBLY	SUB-C000199		
				G1	PIN & SEAL ASSEMBLY	SUB-C000111	
				D3	INNER DryGuard™ CONE	PLC-C100044	
					DryGuard™ FLOAT RING	PLC-C100046	
A	<b>REFRIGERATION REPLACEMENT SYSTEM 115V</b>		G	<b>CRYSTAL GUARD ASSEMBLY WHITE</b>		SUB-C000097	
	A1	EVAPORATOR CATCH		FAS-C000026	CRYSTAL GUARD ASSEMBLY GRANITE	SUB-C000151	
	A2	EVAPORATOR LATCH - R RESERVOIR		FAS-C100004	G1	PIN & SEAL ASSEMBLY	SUB-C000111
	A4	COLD CONTROL		REF-C000012	G2	ARROW CLIP	PLC-C000171
		COLD CONTROL DUST COVER		MIS-C100035	G3	CRYSTAL GUARD WHITE	PLC-C000084
	A5	RELAY 115V (LG)		REF-C000004	G3	CRYSTAL GUARD GRANITE	PLC-C000173
	A6	RELAY 115V (TECUMSEH / KK)		REF-C100096	G4	CRYSTAL GUARD FLOAT & SEAL ASSEMBLY	SUB-C000110
CUTOUT 115V (LG)		REF-C000002	G5	AIR FILTER ASSEMBLY	SUB-C000214		
A7	CUTOUT 115V (TECUMSEH / KK)	REF-C100094	G6	GASKET, CRYSTAL GUARD	SIL-C000009		
	COMPRESSOR DUST COVER (LG)	REF-C100040					
	COMPRESSOR DUST COVER (KK)	REF-C100098					