

Product Specification & Parts Listing

Iceberg Undersink Water Cooler

The Iceberg is our innovative new undersink water cooler, which supplies cooled, filtered water on demand from a counter-mounted tap adjacent to your sink or handbowl. The impressively quiet electric refrigerator installs discretely inside your base cupboard and can dispense a cool 4 litres an hour.



Model: Iceberg 100-115VAC

Standard Cooler Specifications and Performance Data

ITEM		SPECIFICATIONS
POWER RATING		SINGLE PHASE
		100-115VAC 60Hz
STANDARD CURRENT		C&C: 1.2A
POWER CONSUMPTION	COLD	80W
	HOT	-
COLD	COMPRESSOR	SINGLE PHASE MOTOR
	REFRIGERANT	R-134a (30g)
	TEMP RANGE	6°C ± 3°C (43°F ± 6°F)
	TEMP. CONTROL	THERMOSTAT (ON 0°C TO 8.9°C ±1.5°C) (OFF -17.8°C ±1.5°C)
HOT	HEATER	-
	TEMP RANGE	-
	SAFETY DEVICE	-
	TEMP CONTROL	-
NET WEIGHT		12.7kg
DIMENSION		410(W)x300(D)x290(H)mm

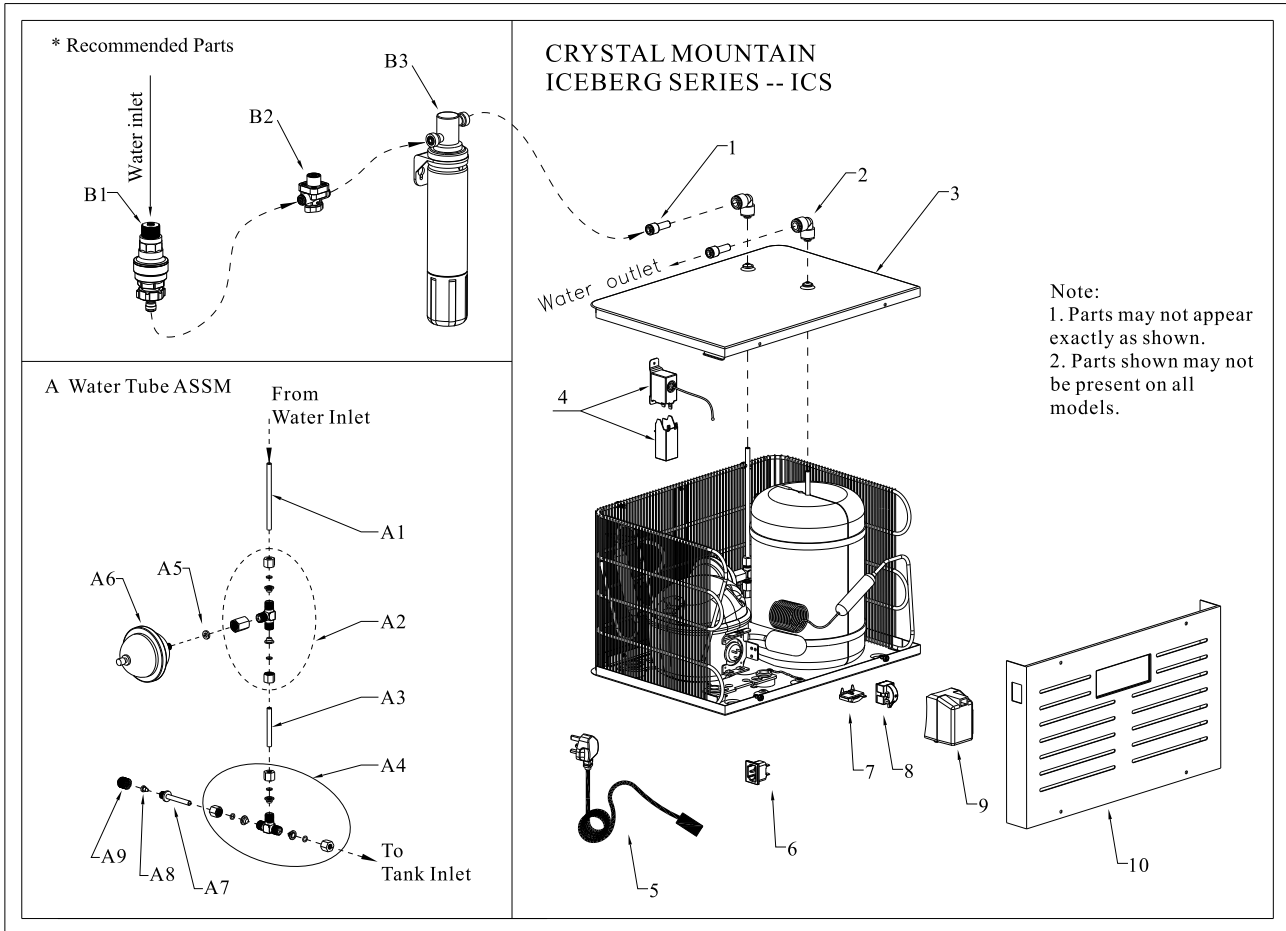

**CRYSTAL MOUNTAIN
115V ICEBERG SERIES (ICS) POU TYPE WATER COOLER**

NO.	DESCRIPTION	PART CODE	NO.	DESCRIPTION	PART CODE	
1	1/4" PF x 3/8" STRAIGHT REDUCER	POU-C100015	A	WATER TUBE ASSM	N/A	
2	1/4" PF SUPERSEAL x 3/8" PF ELBOW	POU-C100002		A1	SS TUBE 1/4" X 178MM	SMT-C100053
3	ICEBERG TOP COVER	SMT-C100008		A2	1/4" MALE TEE W/HEX CONNECTOR	BRS-C100024
4	INTERNAL COLD CONTROL	REF-C100035		A3	SS TUBE 1/4" X 58MM	SMT-C100052
4	COLD CONTROL DUST COVER	MIS-C100035		A4	1/4" MALE TEE	BRS-C100020
5	POWER CORD 115V	ELE-C100025		A5	GASKET - TEE TO SHOCK ARRESTOR	SIL-C100054
6	IEC PLUG	ELE-C000013		A6	SHOCK ARRESTOR - 1/4" MALE BSP	POU-C100001
7	CUTOUT 115V (LG)	REF-C000002		A7	SS DRAIN TUBE W/FITTING	SMT-C100072
7	CUTOUT 115V (TECUMSEH / KK)	REF-C100094		A8	RED DRAIN CAP PLUG	SIL-C100055
8	RELAY 115V (LG)	REF-C000004		A9	HOT TANK DRAIN CAP	PLC-C100004
8	RELAY 115V (TECUMSEH / KK)	REF-C100096	B	*RECOMMENDED PARTS		
9	COMPRESSOR DUST COVER (LG)	REF-C100040		B1	**WATER BLOCK	N/A
9	COMPRESSOR DUST COVER (KK)	REF-C100098		B2	PRESSURE REDUCING VALVE	POU-C000009
10	ICEBERG BACK COVER	SMT-C100009	B3	**FILTER ASSEMBLY	N/A	
**CONTACT SALES OFFICE FOR DETAILS						